



# LION'S WOOD BANQUET FURNITURE

502 South Mount Street, Baltimore, MD 21223



443-763-3620

## QUICK SHIP SKIPJACK BAR



Info@lwbanquetfurniture.com



www.lwbanquetfurniture.com

### Specifications:

- **Dimensions:** 33"W x 72"L x 48"H
- **Weight:** 450 lbs.
- **Countertop:** Removable Exterior-Grade HDPE (High Density Polyethylene)
- **Metal Chassis:** One-piece construction; 304 series Stainless Steel, 16-gauge stainless steel
- **Façade/Body Construction:** Applied Laminate over Furniture-grade plywood
- **Operator's Side:** (1) Insulated ice bin with cover and drain valve, (2) Removable speed rails, Open storage for glass racks and supplies
- **Metal Accents:** Brushed Stainless Steel for corner guards and kick plate
- **Casters:** (4) 5" Heavy-duty swivel casters, (2 locking, 2 non-locking)



**304 series heavy-duty  
Stainless Steel chassis**

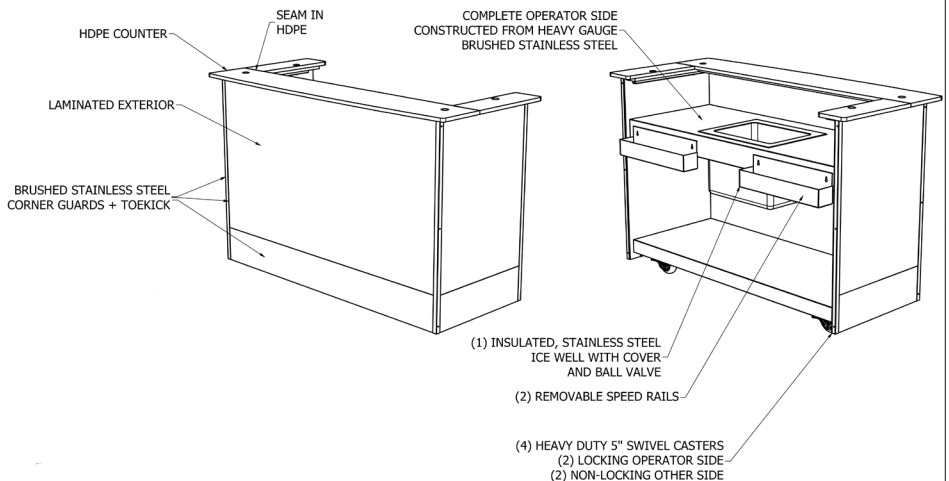

## Exterior-Grade Top:



Oak



Birch

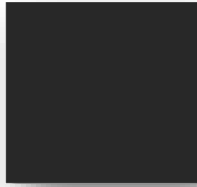

Solid Black

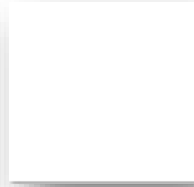

Polar White



Mercury Grey

## Laminate Body:



Black

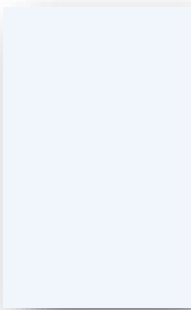

White



Antique  
Marula  
Pine

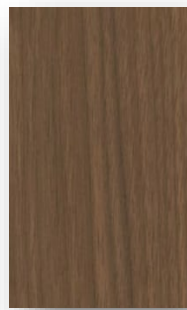

Neo  
Walnut



Hampton  
Walnut



**OPTIONAL PROTECTIVE  
COVER**



MODEL	TOP	BODY
QS-SKIBAR-O-B	Oak	Black
QS-SKIBAR-O-W	Oak	White
QS-SKIBAR-O-AMP	Oak	Antique Marula Pine
QS-SKIBAR-O-NW	Oak	Neo Walnut
QS-SKIBAR-O-HW	Oak	Hampton Walnut
QS-SKIBAR-B-B	Birch	Black
QS-SKIBAR-B-W	Birch	White
QS-SKIBAR-B-AMP	Birch	Antique Marula Pine
QS-SKIBAR-B-NW	Birch	Neo Walnut
QS-SKIBAR-B-HW	Birch	Hampton Walnut
QS-SKIBAR-SB-B	Solid Black	Black
QS-SKIBAR-SB-W	Solid Black	White
QS-SKIBAR-SB-AMP	Solid Black	Antique Marula Pine

MODEL	TOP	BODY
QS-SKIBAR-SB-NW	Solid Black	Neo Walnut
QS-SKIBAR-SB-HW	Solid Black	Hampton Walnut
QS-SKIBAR-PW-B	Polar White	Black
QS-SKIBAR-PW-W	Polar White	White
QS-SKIBAR-PW-AMP	Polar White	Antique Marula Pine
QS-SKIBAR-PW-NW	Polar White	Neo Walnut
QS-SKIBAR-PW-HW	Polar White	Hampton Walnut
QS-SKIBAR-MG-B	Mercury Grey	Black
QS-SKIBAR-MG-W	Mercury Grey	White
QS-SKIBAR-MG-AMP	Mercury Grey	Antique Marula Pine
QS-SKIBAR-MG-NW	Mercury Grey	Neo Walnut
QS-SKIBAR-MG-HW	Mercury Grey	Hampton Walnut

\*Add 250-300 lbs. per crate/pallet for total shipping weight\*

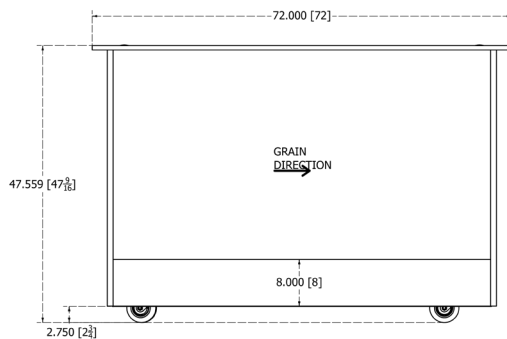
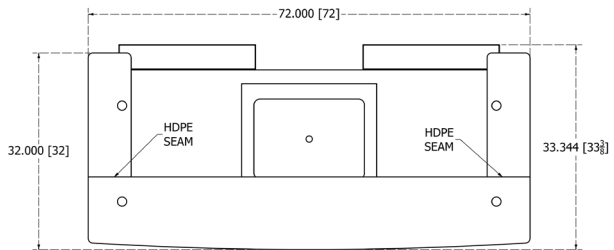
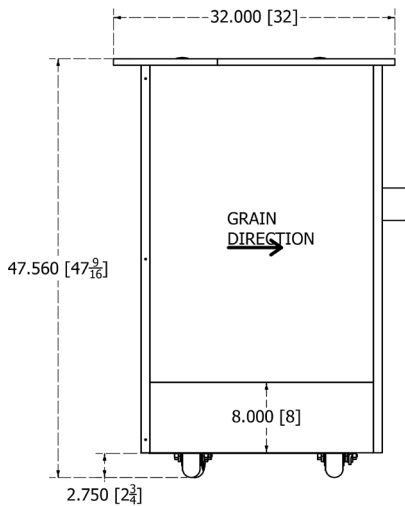

ALL PRODUCTS PROUDLY DESIGNED AND MANUFACTURED IN BALTIMORE, MD, USA

